

## CONNETTORE N MASCHIO 90° X CELLFLEX ½"

**Cod. 212.0011**

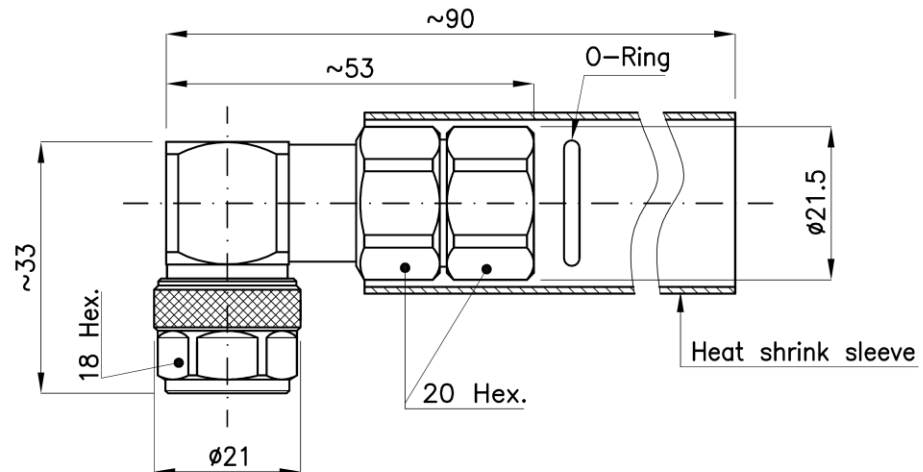

### CHARACTERISTICS

Interface dimensions..... acc. to IEC 60169-16; CECC 122210

### Material and finishings

Body..... Brass-ternary alloy plated  
Center contact..... Spring bronze-silver plated  
Insulator..... PTFE  
Other metal parts..... Brass-nickel plated  
Gasket..... Silicone rubber

### Electrical (\*)

Impedance..... 50Ω  
Frequency range..... DC to 6GHz  
V.S.W.R..... ≤1.045 (33.1dB) DC to 3GHz  
..... ≤1.18 (21.7dB) 3 to 6GHz  
Insulation resistance..... ≥5GΩ  
Proof voltage..... 2.5KVe<sub>eff</sub>.  
Working voltage..... 1.4KVe<sub>eff</sub>.  
Intermodulation product (PIM3)..... ≤-155dBc (2x20W) ; f = ≤1.88GHz  
..... ≤-160dBc typical

(\*) Limitations are possible to the used cable type

### Mechanical

Coupling nut proof torque..... ≤1.7Nm  
Recommended coupling nut torque.. 0.7Nm to 1.1Nm  
Coupling nut retention..... ≥450N  
Mating cycles..... ≥500

### Environmental

Operating temperature..... -55°C to +85°C  
Protection degree(mated conn.)..... IP68 (0.1bar, 24h at 20°C ) acc. to spec. CEI EN60529

### Cable attachment

Center contact..... Plugged-in  
Outer contact..... Clamping

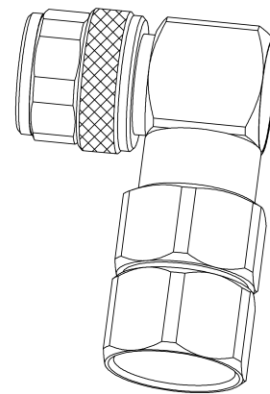

RoHS compliant