

DATASHEET

FTTH IP65 Connectionbox for 96 fiber



Description

Application:

Optical Telecommunication Networks
LAN, Optical fiber Communication Network
CATV Networks
FTTH access Network
PON, G-PON

Delivery unassembled (shrink splice holder, shrink protection and material for wall mounting included)

General data

Scope of application	Outdoor
Mounting	Wall mounting
Possibility of mast mounting	True
Material	Plastic
Colour	Grey
Cable entry without cable gland	16 x 2-3mm; 2 x 15mm; 2 x 18mm
Number of Fibres	96
Type of Splice protection	Thermo
With Fiber overlength cassette	True
Hinged splice cassette	True
Holder for splitter	True
Holder for gas blocker	True
Cable sheath support	True

Mechanical characteristics

IP Protection	IP65
Foreign body and contact protection	Protection against dust deposits
Water protection	Protection against jet water

This datasheet was created automatically on 09-09-2020 . Technical changes reserved.

DATASHEET

FTTH IP65 Connectionbox for 96 fiber

Dimensions

Dimensions	232 x 358.5 x 130.5 mm
------------	------------------------

Environmental conditions

Temperature Range	-25 – 70 °C
-------------------	-------------

Available variants

Title	Access Control
FTTH IP65 Connectionbox for 96 fiber and Fiber overlength box	Special screw/ Seal

DATASHEET

FTTH IP65 Connectionbox for 96 fiber

Technical drawings

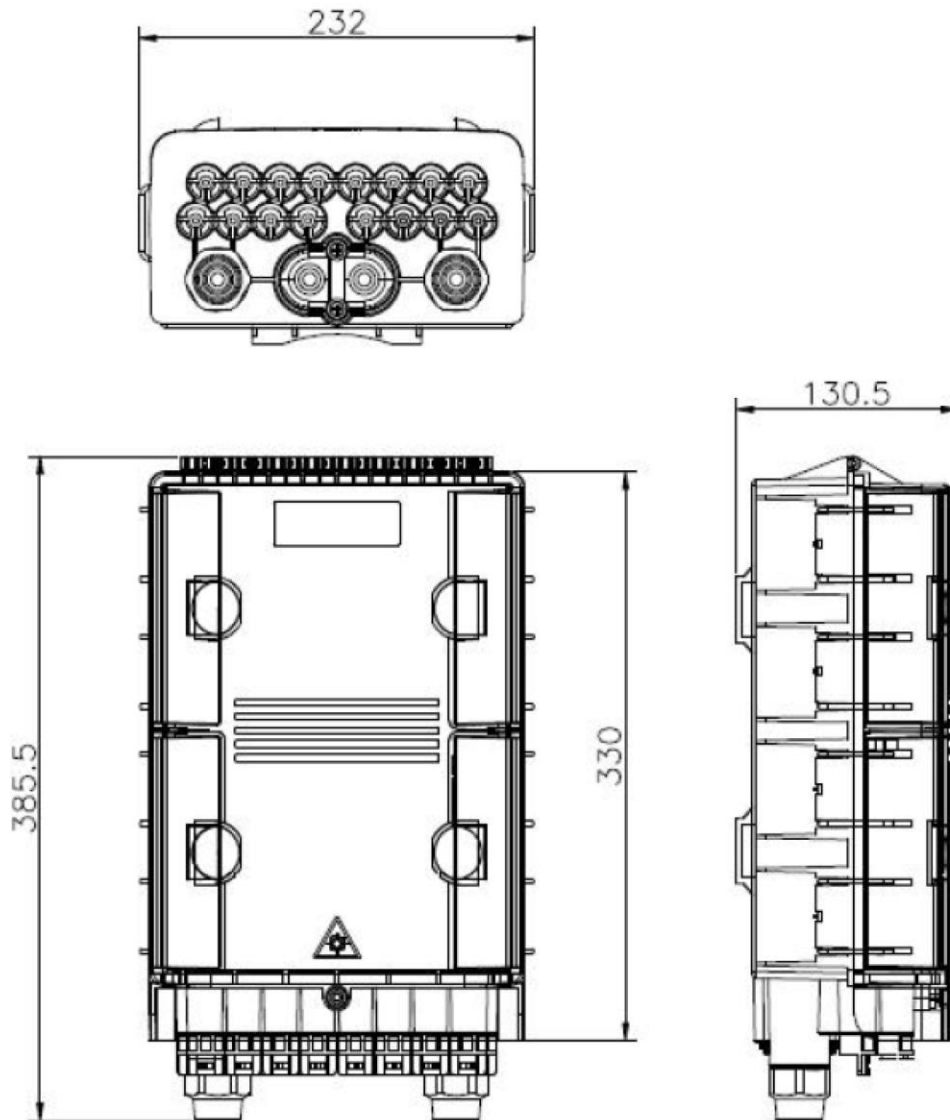

accessory

INFRALAN® U-DQ(ZN)BH 9/125μ, G657A1 B2ca
Easy Splice Pigtailset LC

This datasheet was created automatically on 09-09-2020 . Technical changes reserved.

DATASHEET

FTTH IP65 Connectionbox for 96 fiber

accessory

LC Fiber Pigtail Set 12-colours
LC Fiber Pigtail
Easy Splice Pigtailset SC
SC Fiber Pigtail Set 12-colours
3-Axis Fusionsplicer Inno View 7