

CONNETTORE 7/16" MASCHIO 90° X CLX 1/2"

Cod. 213.0003

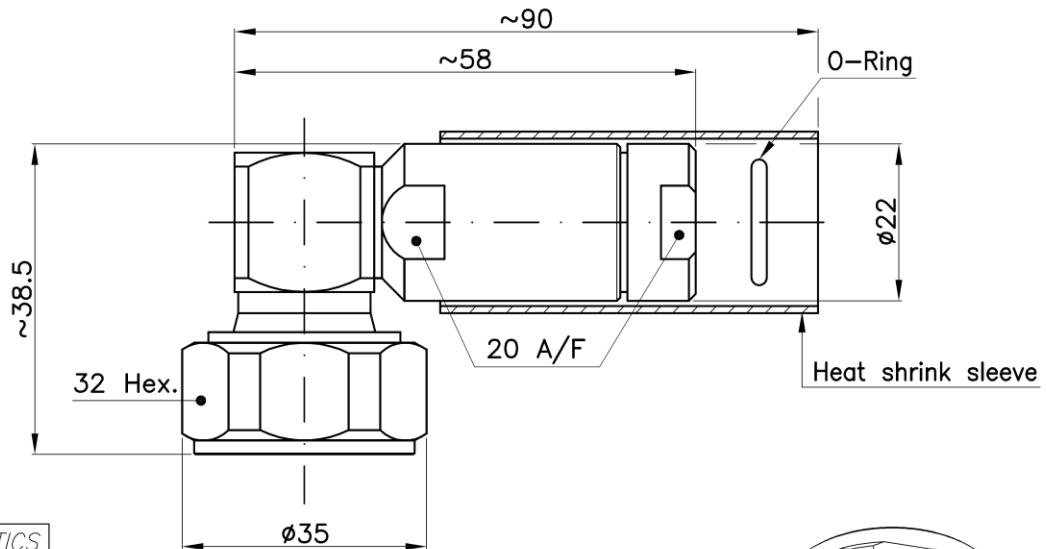

CHARACTERISTICS

Interface dimensions..... acc. to IEC 60169-4; CECC 122190

Material and finishings

Body Brass-ternary alloy plated
 Inner contact..... Spring bronze-silver plated
 Insulator..... PTFE /PE
 Other metal parts..... Brass-nickel plated
 Gasket..... Silicone rubber

Electrical

Impedance..... 50Ω
 Frequency range..... DC to 6 GHz
 (*) V.S.W.R..... ≤1.035 (35.3dB) DC to 3GHz
 ≤1.18 (21.7dB) 3 to 6GHz
 Insulation resistance..... ≥10GΩ
 Proof voltage..... 4KVeFF.
 Working voltage..... 2.7KVeFF.
 Intermodulation product (PIM3)..... ≤-155dBc (2x20W) ; f = ≤1.88GHz
 ≤-160dBc typical

(*) Limitations are possible to the used cable type

Mechanical

Coupling nut proof torque..... ≤35Nm
 Recommended coupling nut torque.. 25Nm to 30Nm
 Coupling nut retention..... ≥1000N
 Mating cycles..... ≥500

Environmental

Operating temperature..... -55°C to +85°C
 Protection degree(mated conn.)..... IP68 (0.1bar, 24h at 20°C) acc. to spec. CEI EN60529

Cable attachment

Center contact..... Plugged-in
 Outer contact..... Clamping

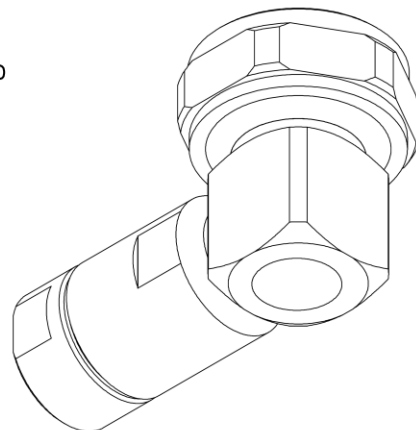

RoHS compliant

ASSEMBLY INSTRUCTIONS : 93.000.102-203